

1990

Spring Ceremonial Script, April 21, 1990

Eastern Michigan University

EASTERN MICHIGAN UNIVERSITY
SPRING COMMENCEMENT
Saturday, April 21, 1990
Bowen Field House

Assemble in Warner by 9:30 a.m. Procession begins at 9:45 a.m.

President:	William E. Shelton
Grand Marshal:	Ranjit Tirtha
Marshals of Faculty:	Sandra E. McClennen and Leroy Watts
Marshals of Graduates:	Charles T. Anderson, John Jellema, Erik Lokensgard and Robert Willoughby
Speaker:	Simon Asher Levin
Honorary Degree Recipient:	Donna Corene Rhodes
Music:	The EMU Symphonic Concert Winds Max Plank, Conductor

DOORS TO BOWEN FIELD HOUSE WILL OPEN AT 8:45 a.m.

FACULTY robe in Gym B, Warner (use FRONT entrance).

BACHELOR'S DEGREE STUDENTS robe in Dance Studio & Wrestling Room.

HONORS STUDENTS assemble in Room 111, Warner.

MASTER'S, CASCI AND SPECIALIST'S DEGREE STUDENTS robe in Gym C, Warner.

GRADUATING STUDENTS USE THE SOUTH EAST ENTRANCE OF WARNER.

PLATFORM PARTICIPANTS (Regents, President, etc.) assemble in Room 241, Warner (use FRONT entrance).

Handicapped seating is available on the Northwest side of Bowen. Call 487-2237 for information about all handicapped seating.

Public parking is available in all University lots and the parking structure.

Commencement Rehearsal is scheduled for Thursday, April 19 at 4:00 p.m. in Bowen Field House. Attendance is NOT mandatory.

Questions regarding individual student records pertaining to graduation should be directed to Graduation Audit for undergraduates and Graduate School for graduates.

WINTER COMMENCEMENT
Saturday, April 21, 1990

PROCESSIONAL

Left-Row 2	Tirtha (Mace)	
	-Color Guard-	
	Student Marshals	
Main Floor	Anderson Willoughby	Main Floor Jellema Lokensgard
	Honor Students Undergraduates Master's CASCI's Specialist's	
	Faculty Marshals	
Main Floor	Watts	Main Floor McClennen
	Faculty	
Left-Row 3	Fish Tubbs Westerman King Ristau	
Left-Front	Plaxco	Brandon
Left-Row 2	Johnson	Goldenberg
Left-Row 2	Bennion	Boone
Left-Row 2	McKelvey	White
Left-Row 3	Rudisill	Right-Row 2
Right-Row 3	Robertson	Aebersold
Right-Row 3	Beagen	Bird
Right-Row 3	Aldridge	Sims
Left-Row 1	Collins - Book Smith - Colors	Right-Row 1
Left-Row 1	Pichette - Keys Wilbanks - Charter Colaianne - Seal	Right-Row 1 Left-Row 2 Right-Row 1
Left-Row 1	Rhodes Guastello	Right-Row 1 Levin Derezinski
Left-Row 1	Burton (on stage, not processing) Shelton	Right-Row 1

SPRING COMMENCEMENT
Saturday, April 21, 1990

STAGE SEATING CHART

BOWEN FIELD HOUSE

Mace Table

● Plaxco (signer)

- | | | |
|-------------|-------------|-------------|
| ● Wilbanks | ● Tirtha | ● Rudisill |
| ● Smith | ● McKelvey | ● Ristau |
| ● Guastello | ● Bennion | ● King |
| ● Rhodes | ● Johnson | ● Westerman |
| ● Burton | ● Colaianne | ● Tubbs |
| | | ● Fish |

Lectern

Row 1

Row 2

Row 3

- | | | |
|--------------|--------------|-------------|
| ● Shelton | ● Brandon | ● Robertson |
| ● Levin | ● Goldenberg | ● Aebersold |
| ● Derezinski | ● Boone | ● Beagen |
| ● Collins | ● White | ● Bird |
| ● Pichette | | ● Aldridge |
| | | ● Sims |

EASTERN MICHIGAN UNIVERSITY
 BOWEN FIELD HOUSE
 COMPETITION

X HANDICAPPED ENTRANCE RAMP

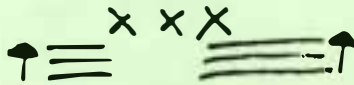

RESTROOMS

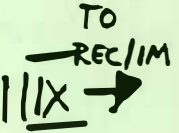

HANDICAPPED SEATING HEARING IMPAIRED

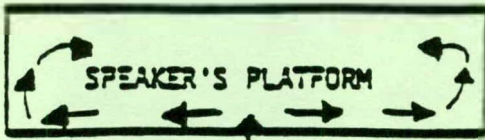

PRESENTATION STAGE

ORCHESTRA

BLEACHERS

RESERVED

FACULTY
 MASTERS

FACULTY
 SPECIALISTS
 CASCI MASTERS

RESERVED

BLEACHERS

BLEACHERS

CHAIRS - BACHELORS

WHEELCHAIR SEATING
 BACHELORS

WHEELCHAIR SEATING
 HONORS
 BACHELORS

CHAIRS - BACHELORS

TREASURE SEATS

RESTROOM

BLEACHERS

RESTROOM

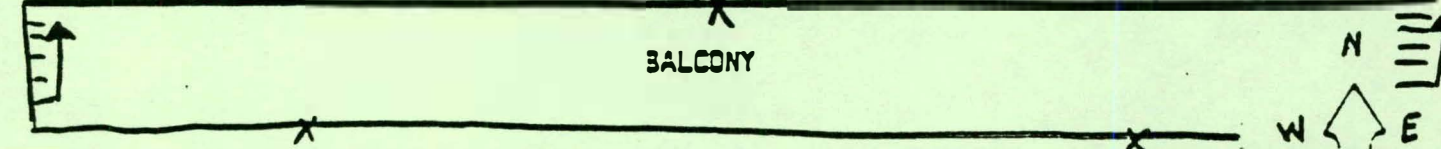

BALCONY

N

W

E

RESTROOMS

STREET LEVEL

X = EXITS ≡ = STAIRS • = RESTROOMS

EASTERN MICHIGAN UNIVERSITY
COMMENCEMENT SCRIPT
SPRING COMMENCEMENT
Saturday, April 21, 1990
Bowen Field House
9:45 a.m.

PROCESSIONAL
(University Symphonic Concert Winds)

GRAND MARSHAL Ranjit Tirtha enters center aisle, ascends stage, turns left and remains standing beside the table at the front holding the mace. When the procession is over, the Grand Marshal places the mace on the table, goes to his chair and remains standing.

COLOR GUARD enter center aisle, ascend stage, split and remain in "hold" position. Flags are posted after the National Anthem.

PLATFORM GUESTS enter center aisle, ascend stage and remain standing in front of their chairs.

PRESIDENT SHELTON enters and assumes the lectern.

PRESIDENT SHELTON: MEMBERS OF THE BOARD OF REGENTS, DISTINGUISHED FACULTY, GRADUATES, PARENTS, FAMILIES AND FRIENDS, WELCOME TO EASTERN MICHIGAN UNIVERSITY'S 1990 SPRING COMMENCEMENT.

PLEASE JOIN ERNEST BRANDON, ASSOCIATE PROFESSOR OF MUSIC, IN SINGING OUR NATIONAL ANTHEM. WE WILL BE ACCOMPANIED BY THE UNIVERSITY SYMPHONIC CONCERT WINDS, CONDUCTED BY MAX PLANK.

(Men remove caps. Dr. Brandon assumes the lectern. Colors are dipped during the National Anthem.)

DR. BRANDON: (National Anthem)

(Remain standing. After the National Anthem, ROTC Color Guard post flags and leave stage. Dr. Brandon returns to his chair and remains standing. President Shelton assumes the lectern.)

PRESIDENT SHELTON: PLEASE BE SEATED. I WOULD LIKE TO TAKE THIS OPPORTUNITY TO INTRODUCE THE DISTINGUISHED MEMBERS OF OUR BOARD OF REGENTS ON WHOSE AUTHORITY DEGREES ARE GRANTED. PLEASE HOLD YOUR APPLAUSE UNTIL THEY HAVE BEEN INTRODUCED.

(Regents, rise as your name is called.)

PRESIDENT SHELTON:

CHAIRMAN JOHN BURTON OF YPSILANTI
ANTHONY DEREZINSKI OF ANN ARBOR
THOMAS GUASTELLO OF MOUNT CLEMENS

(Regents, please be seated.)

AND NOW, I WOULD LIKE TO INTRODUCE THE VICE PRESIDENTS AND
DEANS OF EASTERN MICHIGAN UNIVERSITY.

(Vice Presidents and Deans please stand briefly and be recognized.)

LEADING OUR PROCESSION TODAY IS GRAND MARSHAL DR. RANJIT
TIRTHA. (Dr. Tirtha stands.) DR. TIRTHA IS A PROFESSOR EMERITUS
OF GEOGRAPHY AND GEOLOGY.

(Dr. Tirtha sits down.)

OUR FACULTY MARSHALS ARE LEROY WATTS, PROFESSOR OF SOCIAL
WORK AND SANDRA MC CLENNEN, PROFESSOR OF SPECIAL EDUCATION.

(Faculty marshals rise and sit down as their names are called.)

OUR STUDENT MARSHALS ARE CHARLES ANDERSON, PROFESSOR
EMERITUS OF CHEMISTRY; JOHN JELLEMA, PROFESSOR OF INDUSTRIAL
TECHNOLOGY; ERIC LOKENSGARD, PROFESSOR OF INDUSTRIAL
TECHNOLOGY; AND ROBERT WILLOUGHBY, PROFESSOR OF HEALTH,
PHYSICAL EDUCATION, RECREATION AND DANCE.

(Marshals rise and sit down as their names are called.)

PRESIDENT SHELTON: AND NOW, MAY I INTRODUCE YOU TO THE MEMBERS OF
OUR FACULTY WHO REPRESENT THE ACADEMIC DEPARTMENTS OF THE
UNIVERSITY ON WHOSE RECOMMENDATION CANDIDATES FOR DEGREES ARE
PRESENTED. FACULTY MEMBERS, PLEASE RISE AND BE RECOGNIZED.

(Faculty rise and sit down.)

I WOULD ALSO LIKE TO INTRODUCE YOU TO JEFF PLAXCO WHO

PRESIDENT SHELTON: WILL SERVE AS A SIGNER FOR OUR HEARING IMPAIRED GUESTS.

(Mr. Plaxco stands and is seated.)

PRESIDENT SHELTON: EASTERN MICHIGAN UNIVERSITY EMPHASIZES SIX AREAS OF STUDY: THE ARTS AND HUMANITIES, BUSINESS, EDUCATION, HEALTH AND HUMAN SERVICES, SCIENCE AND MATHEMATICS, AND TECHNOLOGY. TODAY, AT THIS SPRING COMMENCEMENT, WE ARE SALUTING THE SCIENCE AND MATHEMATICS AREAS OF STUDY.

THE TEN NATURAL AND SOCIAL SCIENCE DEPARTMENTS AT EASTERN MICHIGAN STRIVE TO FULFILL THE UNIVERSITY'S MISSION TO PROMOTE AN EXCEPTIONAL LEARNING ENVIRONMENT, EXPAND KNOWLEDGE THROUGH RESEARCH AND TEACHING, AND EXHIBIT LEADERSHIP THROUGH PUBLIC SERVICE. ALTHOUGH WIDE RANGING IN CONTENT, THE SCIENCES AND MATHEMATICS DEPARTMENTS SHARE COMMON GOALS TO DEVELOP SCIENTIFIC LITERACY AND PROBLEM SOLVING AMONG ALL STUDENTS AND PROVIDE MAJORS WITH SUPERIOR PREPARATION FOR REWARDING CAREERS.

EASTERN'S NATURAL AND SOCIAL SCIENCE FACULTY HAVE WON BOTH NATIONAL AND STATE RECOGNITION FOR THEIR TEACHING EXCELLENCE AND RESEARCH CONTRIBUTIONS AND NATIONAL ACCLAIM FOR THE SCIENCE TEACHER PREPARATION PROGRAM.

EASTERN MICHIGAN UNIVERSITY TAKES PRIDE IN THE FACULTY, STUDENTS, AND THE ACADEMIC PROGRAMS IN THE FIELDS OF MATHEMATICS AND SCIENCE.

IN CELEBRATION OF SCIENCE AND MATHEMATICS, AND ON THE EVE OF THE TWENTIETH ANNIVERSARY OF EARTH DAY, WE ARE HONORED TO HEAR THE THOUGHTS OF NOTED SCHOLAR, MATHEMATICIAN, AND SCIENTIST, SIMON ASHER LEVIN. DR. LEVIN CURRENTLY HOLDS JOINT APPOINTMENTS

PRESIDENT SHELTON: AT CORNELL UNIVERSITY AS CHARLES A. ALEXANDER
PROFESSOR OF BIOLOGICAL SCIENCES AND PROFESSOR OF APPLIED
MATHEMATICS AND ECOLOGY. HE IS ALSO THE DIRECTOR OF THE CENTER
FOR ENVIRONMENTAL RESEARCH WHICH ADMINISTERS SEVERAL
INTERDISCIPLINARY ENVIRONMENTAL UNITS ON THE CORNELL CAMPUS.

DR. LEVIN RECEIVED A BACHELOR OF ARTS DEGREE FROM JOHNS
HOPKINS UNIVERSITY IN 1961 AND A PH.D. FROM THE UNIVERSITY OF
MARYLAND IN 1964 IN MATHEMATICS. AFTER A ONE YEAR FELLOWSHIP AT
THE UNIVERSITY OF CALIFORNIA AT BERKELEY, HE ASSUMED A POSITION
AS ASSISTANT PROFESSOR OF MATHEMATICS AT CORNELL AND HAS
REMAINED THERE TO THE PRESENT. IN ADDITION TO HIS WORK AT
CORNELL, DR. LEVIN HAS HELD FELLOWSHIPS, GUEST AND VISITING
LECTURER POSITIONS AT NO FEWER THAN TEN UNIVERSITIES INCLUDING
UNIVERSITY OF OXFORD, UNIVERSITY OF KYOTO, STANFORD, THE WEIZMANN
INSTITUTE, AND THE UNIVERSITY OF BRITISH COLUMBIA, TO NAME A FEW.

DR. LEVIN COMBINED HIS INTERESTS AND TRAINING IN MATHEMATICS
WITH ECOLOGY IN THE EARLY 1970'S. HE RECEIVED A JOINT APPOINTMENT
IN THE DEPARTMENT OF ECOLOGY AND SYSTEMATICS IN 1972 AND SERVED
AS CHAIR OF THE DEPARTMENT. IN 1980 DR. LEVIN BECAME THE
DIRECTOR OF THE NEWLY ESTABLISHED ECOSYSTEMS RESEARCH CENTER
AT CORNELL REMAINING IN THAT POST UNTIL 1987. DURING THIS PERIOD
HE BECAME ACTIVELY INVOLVED IN APPLIED ENVIRONMENTAL PROBLEMS
WHICH CONTINUE TO OCCUPY HIS ATTENTION AS DIRECTOR OF THE CENTER
FOR ENVIRONMENTAL RESEARCH.

AN OUTSTANDING SCHOLAR, DR. LEVIN HAS OVER 150 PUBLICATIONS
TO HIS CREDIT AND HAS BEEN A PARTICIPANT IN OVER 65 ADDRESSES
AND LECTURE SERIES. HE HAS ALSO SERVED ON EDITORIAL BOARDS

PRESIDENT SHELTON: OF COUNTLESS SCIENTIFIC JOURNALS AND PUBLICATIONS.

DR. LEVIN HAS FOCUSED HIS RESEARCH ON ENVIRONMENTAL PROBLEMS AND THE IMPACT OF THE ENVIRONMENT ON HUMANS. BECAUSE OF HIS ABILITY TO SUCCESSFULLY APPLY THE RIGOR AND INSIGHT OF THEORY TO THE PRACTICAL PROBLEMS FACING SOCIETY, SIMON LEVIN IS AMONG A SELECT GROUP OF SCIENTISTS WHO ARE ACTIVELY INFLUENCING THE DIRECTION OF RESEARCH AND POLICY IN ECOLOGY AND ENVIRONMENTAL SCIENCE.

LADIES AND GENTLEMEN, I WOULD LIKE TO PRESENT TO YOU DR. SIMON LEVIN.

(President Shelton is seated. Dr. Levin assumes the lectern.)

DR. LEVIN: (Commencement Address)

(Following the Commencement Address, Dr. Levin returns to his chair. President Shelton assumes the lectern.)

PRESIDENT SHELTON: THANK YOU DR. LEVIN FOR YOUR MOST APPROPRIATE MESSAGE. (Pause).

AS WE CONTINUE THE TRADITION OF HONORING THOSE PERSONS WHOSE CONTRIBUTIONS, MERITORIOUS PUBLIC SERVICE OR OTHER ACHIEVEMENTS HAVE BROUGHT THEM THE HIGH ESTEEM OF THEIR COMMUNITIES, IT IS OUR PRIVILEGE TO RECOGNIZE TWO SUCH INDIVIDUALS TODAY WHO HAVE MADE SIGNIFICANT CONTRIBUTIONS AS ADVOCATES OF LEARNING AND EDUCATION.

(Dr. Collins picks up the hood from under his chair. Dean Fish picks up the certificate and diploma from under his chair. Both escort Dr. Levin to a position three feet to the right and one foot back of President Shelton.)

PRESIDENT SHELTON: AS A LEADER IN THE FIELD OF ENVIRONMENTAL RESEARCH AND ECOLOGY, DR. SIMON ASHER LEVIN HAS CONTRIBUTED GREATLY TO THE UNDERSTANDING OF ENVIRONMENTAL ISSUES OF OUR TIMES. HIS

PRESIDENT SHELTON: COMBINATION OF THEORY AND PRACTICAL APPLICATION HAS GIVEN DIRECTION AND SHAPE TO ENVIRONMENTAL POLICIES. HE HAS ENERGETICALLY GIVEN OF HIMSELF TO HIS DISCIPLINE AND TO STUDENTS THROUGH HIS RESEARCH, HIS EDITORIAL WORK, HIS LECTURES, AND HIS CONTRIBUTIONS TO HIS UNIVERSITY THROUGH HIS SERVICE.

IN RECOGNITION OF HIS MANY CONTRIBUTIONS, EASTERN MICHIGAN UNIVERSITY IS PROUD TO CONFER UPON SIMON ASHER LEVIN THE HONORARY DEGREE OF DOCTOR OF SCIENCE. TO CONFER THE DEGREE UPON DR. LEVIN, I CALL UPON THE HONORABLE JOHN BURTON. REGENT BURTON WILL BE ASSISTED BY DR. RONALD COLLINS, PROVOST AND VICE PRESIDENT FOR ACADEMIC AFFAIRS, AND DR. BARRY FISH, DEAN OF THE COLLEGE OF ARTS AND SCIENCES.

(President Shelton steps to his left and Regent Burton assumes the lectern.)

(Dean Fish hands the citation to Regent Burton. At the appropriate time, Dr. Collins assists with the hooding and Dean Fish hands the diploma to Dr. Levin.)

REGENT BURTON: AS A DEDICATED ENVIRONMENTALIST AND SCIENTIST, YOU HAVE APPLIED MATHEMATICS TO DESCRIBE ECOLOGICAL PROBLEMS AND PROVIDE SOLUTIONS. THROUGH YOUR UNTIRING EFFORTS, YOU HAVE MADE A SIGNIFICANT CONTRIBUTION TO THE QUALITY OF LIFE OF THE GENERATIONS TO COME. YOUR EFFORTS TO COORDINATE THE WORK OF BOTH ACADEMICIANS AND POLICY MAKERS HOLD SPECIAL SIGNIFICANCE AS THE WORLD CELEBRATES THE TWENTIETH ANNIVERSARY OF EARTH DAY.

EASTERN MICHIGAN UNIVERSITY IS THUS PROUD TO CONFER UPON SIMON ASHER LEVIN THE DEGREE, DOCTOR OF SCIENCE, WITH ALL THE RIGHTS, PRIVILEGES AND RESPONSIBILITIES PERTAINING THERETO. IN TOKEN THEREOF, I CAUSE YOU TO BE VESTED WITH THE HOOD OF THIS

REGENT BURTON: DEGREE AND PRESENT YOU WITH A DIPLOMA AND A CITATION.

(Regent Burton then hands the citation to Dr. Levin.)

(Dr. Levin may make a few remarks before returning to his seat.)

(Dr. Collins and Dean Fish escort Dr. Levin to his chair. Regent Burton returns to his chair. President Shelton assumes the lectern.)

(Dr. Collins picks up the remaining hood from under his chair. Dean Fish picks up the certificate and diploma from under his chair. Both escort Dr. Rhodes to a position three feet to the right and one foot back of President Shelton.)

PRESIDENT SHELTON: DR. DONNA CORENE RHODES SHARES DR. LEVIN'S DESIRE FOR IMPROVING THE QUALITY OF LIFE FOR ALL PEOPLE. DR. LEVIN'S SPHERE OF INFLUENCE IS THE ENVIRONMENT; DR. RHODES' IS THE EDUCATIONAL SYSTEM.

AS THE EXECUTIVE DIRECTOR OF THE NATIONAL FOUNDATION FOR THE IMPROVEMENT OF EDUCATION, DR. RHODES IS RESPONSIBLE FOR SETTING AND IMPLEMENTING THE VISION OF THE FOUNDATION TO ENABLE TEACHERS AND OTHERS WHO SUPPORT THE EDUCATION OF OUR NATION'S CHILDREN TO USE THEIR TALENTS CREATIVELY AND EFFECTIVELY. THE FOUNDATION, UNDER DR. RHODES' LEADERSHIP, IS WORKING WITH BUSINESS AND THE MEDIA TO PROVIDE POSITIVE AND CONSTRUCTIVE REFORMS IN THE FIELD OF EDUCATION TO MEET THE CHALLENGES OF A CHANGING SOCIETY.

TO ADDRESS THESE CHALLENGES, DR. RHODES DESIGNED AND IMPLEMENTED THREE NATIONAL PROGRAMS FOCUSING ON TEACHER LEADERSHIP: OPERATION RESCUE, A NATIONAL DROPOUT PREVENTION PROGRAM; THE CHRISTA MC AULIFFE INSTITUTE FOR EDUCATIONAL PIONEERING; AND LEARNING TOMORROW, A PROGRAM TO FOSTER THE USE OF TECHNOLOGY IN SCHOOL RESTRUCTURING.

PRESIDENT SHELTON: IN ADDITION TO POLICY AND PROGRAM DEVELOPMENT AND ADMINISTRATION, DR. RHODES CONTINUES TO CONDUCT RESEARCH, PUBLISH AND SERVE AS A HIGHLY SOUGHT AFTER SPOKESPERSON FOR EDUCATIONAL RESTRUCTURING. SHE FREQUENTLY APPEARS ON NATIONAL TELEVISION, DELIVERS COUNTLESS ADDRESSES, AND PRESENTS PAPERS.

DONNA RHODES HAS BEEN COMMITTED TO EDUCATION THROUGHOUT HER LIFE. SHE ATTENDED THE UNIVERSITY OF VIENNA, HOLDS A BACHELOR'S DEGREE FROM THE UNIVERSITY OF CALIFORNIA AT LOS ANGELES, A MASTER'S DEGREE FROM EASTERN MICHIGAN UNIVERSITY, A SPECIALIST DEGREE FROM THE UNIVERSITY OF MICHIGAN, AND A DOCTORATE FROM THE UNIVERSITY OF LOUISVILLE IN PSYCHOLOGY AND EDUCATION.

DR. RHODES OBTAINED FIRST-HAND KNOWLEDGE OF THE EDUCATIONAL SYSTEM AS A TEACHER IN THE GARDEN CITY AND ANN ARBOR PUBLIC SCHOOLS AND THE UNIVERSITY ELEMENTARY SCHOOL AT UCLA. SHE BEGAN TEACHING AT THE UNIVERSITY LEVEL IN 1974 AS A LECTURER AT THE UNIVERSITY OF LOUISVILLE BEFORE BECOMING THE DIRECTOR OF THE INSTITUTE FOR CHILDREN IN KENTUCKY IN 1977. IN 1979, SHE BECAME A FELLOW IN THE INSTITUTE FOR EDUCATIONAL LEADERSHIP IN WASHINGTON, D.C.. AS PART OF THE FELLOWSHIP, SHE WAS A SPECIAL ASSISTANT IN THE OFFICE OF THE ASSISTANT COMMISSIONER FOR PUBLIC AFFAIRS IN THE U.S. OFFICE OF EDUCATION. IN 1980, DR. RHODES WAS APPOINTED INTERIM EXECUTIVE DIRECTOR OF THE INTERGOVERNMENTAL ADVISORY COUNCIL ON EDUCATION AND IN 1982, BECAME THE EXECUTIVE ASSISTANT TO THE PRESIDENT AT CALIFORNIA STATE UNIVERSITY AT FULLERTON. SHE HAS HELD HER PRESENT POSITION AS EXECUTIVE DIRECTOR OF THE NFIE SINCE 1985.

PRESIDENT SHELTON: IN RECOGNITION OF HER MANY CONTRIBUTIONS TO EDUCATION, EASTERN MICHIGAN UNIVERSITY IS PROUD TO CONFER UPON DONNA CORENE RHODES THE HONORARY DEGREE OF DOCTOR OF EDUCATION. TO CONFER HER DEGREE, I CALL UPON THE HONORABLE ANTHONY DEREZINSKI. REGENT DEREZINSKI WILL BE ASSISTED BY DR. RONALD COLLINS AND DR. BARRY FISH.

(President Shelton steps to his left and Regent Derezinski assumes the lectern.)

(Dean Fish hands the citation to Regent Derezinski. At the appropriate time, Dr. Collins assists with the hooding and Dean Fish hands the diploma to Dr. Rhodes.)

REGENT DEREZINSKI: YOU ARE DEEPLY RESPECTED FOR YOUR ONGOING COMMITMENT TO EXCELLENCE IN THE AREA OF EDUCATION. UNDER YOUR LEADERSHIP, THE NATIONAL FOUNDATION FOR THE IMPROVEMENT OF EDUCATION HAS DEVELOPED DROPOUT PREVENTION PROGRAMS AND STRENGTHENED THE QUALITY OF INSTRUCTION IN THIS NATION'S SCHOOLS, THEREBY MAKING A SIGNIFICANT IMPACT ON THE LIVES OF STUDENTS. YOU HAVE TRULY DEMONSTRATED EVERY QUALITY OF AN OUTSTANDING EDUCATOR.

EASTERN MICHIGAN UNIVERSITY IS THUS PROUD TO CONFER UPON DONNA CORENE RHODES THE DEGREE, DOCTOR OF EDUCATION, WITH ALL THE RIGHTS, PRIVILEGES AND RESPONSIBILITIES PERTAINING THERETO. IN TOKEN THEREOF, I CAUSE YOU TO BE VESTED WITH THE HOOD OF THIS DEGREE AND PRESENT YOU WITH THIS DIPLOMA AND CITATION.

(Regent Derezinski then hands the citation to Dr. Rhodes.)

(Dr. Rhodes may make a few remarks before returning to her seat.)

(Regent Derezinski returns to his chair. Dr. Collins and Dean Fish escort Dr. Rhodes to her chair and return to their chairs. President Shelton assumes the lectern.)

PRESIDENT SHELTON: PRESENTATION OF CANDIDATES FOR THE SPECIALIST'S AND MASTER'S DEGREES WILL BE CONDUCTED BY DR. RONALD GOLDENBERG, DEAN OF THE GRADUATE SCHOOL. THE DEGREES WILL BE CONFERRED BY REGENTS THOMAS GUASTELLO AND ANTHONY DEREZINSKI.

(President Shelton is seated. Dr. Goldenberg assumes the lectern. Regent Guastello comes forward and stands at the left of Dr. Goldenberg.)

DR. GOLDENBERG: WILL THE CANDIDATES FOR THE SPECIALIST'S DEGREE AND ADVANCED CERTIFICATES PLEASE RISE. (Candidates rise.)

REGENT GUASTELLO, EACH OF THESE PERSONS HAS COMPLETED A PROGRAM OF ADVANCED STUDIES. THE FACULTY OF EASTERN MICHIGAN UNIVERSITY RECOMMENDS THEM FOR SPECIALIST'S DEGREES AND CERTIFICATES. I PRESENT THEM TO YOU NOW FOR THE CONFERRING OF DEGREES.

(Dean Goldenberg steps back and Regent Guastello assumes the lectern.)

REGENT GUASTELLO: INASMUCH AS YOU HAVE BEEN RECOMMENDED BY THE FACULTY, CONTINGENT UPON COMPLETION OF ALL REQUIREMENTS, AND BY VIRTUE OF THE AUTHORITY VESTED IN ME BY THE BOARD OF REGENTS OF EASTERN MICHIGAN UNIVERSITY AND THE STATE OF MICHIGAN, I CONFER UPON YOU, THE DEGREE TO WHICH YOU ARE ENTITLED WITH ALL THE RIGHTS, PRIVILEGES, AND RESPONSIBILITIES PERTAINING THERETO. PLEASE COME FORWARD TO RECEIVE YOUR DIPLOMA.

(Regent Guastello goes down the stairs to the presentation stage. Candidates are led to the stage by the marshals. Candidates present their name card to the reader who reads the name of the candidate.)

(Dr. Goldenberg assumes the lectern. Regent Guastello is seated and Regent Derezinski approaches the lectern.)

DR. GOLDENBERG: WILL THE CANDIDATES FOR THE MASTER'S DEGREE PLEASE RISE. (Candidates rise.)

DR. GOLDENBERG: REGENT DEREZINSKI, I HEREBY PRESENT THE CANDIDATES FOR THE MASTER'S DEGREES. EACH OF THESE PERSONS HAS COMPLETED A PROGRAM OF ADVANCED STUDIES. THE FACULTY OF EASTERN MICHIGAN UNIVERSITY RECOMMENDS THEM FOR MASTER'S DEGREES. I PRESENT THEM TO YOU NOW FOR THE CONFERRING OF DEGREES.

(Dr. Goldenberg steps back and Regent Derezinski assumes the lectern.)

REGENT DEREZINSKI: INASMUCH AS YOU HAVE BEEN RECOMMENDED BY THE FACULTY, CONTINGENT UPON COMPLETION OF ALL REQUIREMENTS, AND BY VIRTUE OF THE AUTHORITY VESTED IN ME BY THE BOARD OF REGENTS OF EASTERN MICHIGAN UNIVERSITY AND THE STATE OF MICHIGAN, I CONFER UPON YOU, THE MASTER'S DEGREE TO WHICH YOU ARE ENTITLED WITH ALL THE RIGHTS, PRIVILEGES AND RESPONSIBILITIES THERETO. PLEASE COME FORWARD TO RECEIVE YOUR DIPLOMA APPROPRIATE TO THE DEGREE WHICH HAS BEEN CONFERRED UPON YOU.

(Regents Derezinski and Guastello go down the stairs to the presentation stage. Dr. Goldenberg is seated. Candidates are led to the stage by the marshals. Candidates present their name card to the reader, who reads the name of the candidate.)

(Regents Derezinski and Guastello are seated. President Shelton assumes the lectern.)

PRESIDENT SHELTON: WE AT EASTERN MICHIGAN UNIVERSITY WORK VERY HARD TO CREATE AN "HONORS ENVIRONMENT" THAT WILL MAXIMIZE OUR STUDENTS' CHANCES FOR ACADEMIC SUCCESS. FOR YEARS WE HAVE MAINTAINED A STUDENT TO FACULTY RATIO OF APPROXIMATELY TWENTY TO ONE. NEARLY 90 PERCENT OF OUR FACULTY HAVE EARNED DOCTORAL OR TERMINAL DEGREES IN THEIR FIELDS OF SPECIALIZATION, AND THESE FACULTY COMMONLY TEACH INTRODUCTORY CLASSES.

THE UNIVERSITY HONORS PROGRAM WAS ESTABLISHED IN THE FALL OF 1984 TO ATTRACT GIFTED STUDENTS TO THE UNIVERSITY AND PROVIDE

PRESIDENT SHELTON: THEM WITH SPECIAL CHALLENGES AND OPPORTUNITIES TO EXCEL. FORTY-FIVE OUTSTANDING STUDENTS ARE GRADUATING FROM THE UNIVERSITY HONORS PROGRAM THIS SPRING.

IN ADDITION TO COMPLETING THEIR UNDERGRADUATE REQUIREMENTS WITH AN EXCEPTIONAL GRADE POINT AVERAGE, THESE STUDENTS HAVE ALSO UNDERTAKEN THE SPECIAL CHALLENGE OF HONORS WORK WHICH INCLUDES A MAJOR PROJECT, THE SENIOR HONORS THESIS.

AT THIS TIME I WOULD LIKE TO RECOGNIZE THE GRADUATES OF THE UNIVERSITY HONORS PROGRAM. WILL THE GRADUATES FROM THIS PROGRAM STAND AND BE RECOGNIZED. (Pause) PLEASE BE SEATED.

NOW, WE WOULD LIKE TO RECOGNIZE THOSE UNDERGRADUATE STUDENTS GRADUATING WITH ACADEMIC HONORS. MANY OF THESE STUDENTS ARE SEATED TOGETHER AND WILL BE COMING FIRST TO THE STAGE TO RECEIVE THEIR DIPLOMAS. STUDENTS GRADUATING CUM LAUDE PLEASE RISE. (Pause) THESE STUDENTS HAVE ATTAINED A 3.5 TO 3.69 GRADE POINT AVERAGE. PLEASE BE SEATED. STUDENTS GRADUATING MAGNA CUM LAUDE PLEASE RISE. (Pause) THESE STUDENTS HAVE ATTAINED A 3.7 TO 3.89 GRADE POINT AVERAGE. PLEASE BE SEATED. STUDENTS GRADUATING SUMMA CUM LAUDE PLEASE RISE. (Pause) THESE STUDENTS HAVE ATTAINED A 3.9 TO 4.0 GRADE POINT AVERAGE. PLEASE BE SEATED.

PROVOST RONALD COLLINS WILL PRESENT THE CANDIDATES FOR THE BACHELOR'S DEGREES. THE DEGREES WILL BE CONFERRED BY REGENTS DEREZINSKI AND GUASTELLO, AND VICE PRESIDENTS COLLINS, PICHETTE, SMITH, AND WILBANKS.

(President Shelton is seated. Dr. Collins assumes the lectern. Regents Derezinski, Guastello, Vice Presidents Pichette, Smith, and Wilbanks come forward.)

DR. COLLINS: WILL THE CANDIDATES FOR THE BACHELOR'S DEGREE PLEASE RISE. (Candidates rise.)

REGENTS DEREZINSKI AND GUASTELLO AND VICE PRESIDENTS PICHETTE, SMITH, AND WILBANKS, IT IS INDEED A HIGH HONOR AND DISTINCT PRIVILEGE, ON BEHALF OF THE FACULTY OF EASTERN MICHIGAN UNIVERSITY, TO PRESENT TO YOU MEMBERS OF THE UNDERGRADUATE CLASS FOR THE CONFERRING OF BACCALAUREATE DEGREES TO WHICH THEY ARE APPROPRIATELY ENTITLED.

(Dr. Collins steps back and Regent Guastello assumes the lectern.)

REGENT GUASTELLO: INASMUCH AS YOU HAVE BEEN RECOMMENDED BY THE FACULTY, CONTINGENT UPON COMPLETION OF ALL REQUIREMENTS FOR THE BACHELOR'S DEGREE, AND BY THE VIRTUE OF THE AUTHORITY VESTED IN ME BY THE BOARD OF REGENTS OF EASTERN MICHIGAN UNIVERSITY AND THE STATE OF MICHIGAN, I CONFER UPON YOU, THE BACHELOR'S DEGREE TO WHICH YOU ARE ENTITLED WITH ALL OF THE RIGHTS, PRIVILEGES AND RESPONSIBILITIES PERTAINING THERETO. PLEASE COME FORWARD TO RECEIVE THE DIPLOMA APPROPRIATE TO THE DEGREE WHICH HAS BEEN CONFERRED UPON YOU. GRADUATES PLEASE BE SEATED UNTIL THE MARSHALS DIRECT YOU TO COME FORWARD.

(Candidates are led to the stage one row at a time by the marshals. Candidates present their name cards to the readers, who read the name and any honors listed on the card of the candidates. Readers please read only University academic honors - not program or college designations. Please read, where appropriate, summa cum laude, magna cum laude, and cum laude.)

(Regents and Vice Presidents Collins and Pichette proceed to lower stage. Vice Presidents Smith and Wilbanks may return to their seats at this point. Two people will distribute diplomas and shake hands at one time. The Regents will be relieved by Vice Presidents Collins and Pichette and may then return to their seats on the upper stage. Vice Presidents Smith and Wilbanks will proceed to the lower stage and relieve Vice Presidents Collins and Pichette respectively. The Vice

Presidents will relieve each other until all candidates have crossed the stage.)

(After the candidates receive their diplomas, they return to their seats where they remain standing until their entire row has returned, whereupon marshals give the signal to be seated.)

(Vice Presidents are seated. President Shelton assumes the lectern.)

PRESIDENT SHELTON: LADIES AND GENTLEMEN, SEVERAL MEMBERS OF THIS GRADUATING CLASS HAVE COMPLETED THE REQUIRED COURSES IN MILITARY SCIENCE, AND THROUGH THE R.O.T.C., HAVE BEEN SELECTED FOR COMMISSIONS AS SECOND LIEUTENANTS. THEIR NAMES AND RANKS ARE NOTED IN THE COMMENCEMENT PROGRAM. WILL THE R.O.T.C. GRADUATES PLEASE STAND AND BE RECOGNIZED. (Pause) PLEASE BE SEATED.

TO ALL OF THE GRADUATES LEAVING OUR HALLOWED HALLS, I EXPRESS, ON BEHALF OF THE ENTIRE UNIVERSITY, OUR HEARTY CONGRATULATIONS. THE REGENTS, FACULTY, AND STAFF WOULD ALSO LIKE TO CONGRATULATE THE FAMILIES OF OUR GRADUATES. WOULD THE PARENTS AND GRANDPARENTS OF THE GRADUATES PLEASE STAND AND BE RECOGNIZED. (Pause) PLEASE BE SEATED. WOULD THE SPOUSES AND CHILDREN OF THE GRADUATES PLEASE STAND AND BE RECOGNIZED. (Pause) PLEASE BE SEATED. YOUR ENCOURAGEMENT, GUIDANCE AND LOVE HAVE MADE IT POSSIBLE FOR THESE GRADUATES TO EARN THEIR DEGREES.

I NOW PRESENT THE HONORABLE JOHN BURTON, WHO, AS CHAIRMAN OF THE BOARD OF REGENTS, WILL ADDRESS THE GRADUATES.

(President Shelton returns to his chair. Regent Burton assumes the lectern and reads the Charge to the Graduates.)

REGENT BURTON: ON BEHALF OF THE BOARD OF REGENTS AND THE CITIZENS OF THE STATE OF MICHIGAN, I WISH TO CONGRATULATE YOU AND YOUR FAMILIES ON YOUR ACCOMPLISHMENT TODAY. WE ARE ESPECIALLY GLAD THAT YOU WILL BE REPRESENTING US AS LEADERS AND PROFESSIONALS IN

REGENT BURTON: ALL THE FIELDS REPRESENTED BY YOUR DEGREES. WE NEED YOU. THE WORLD NEEDS YOU TO HELP MAKE THIS A SAFER, MORE EQUITABLE AND MORE EFFECTIVE PLACE FOR YOURSELVES AND FUTURE GENERATIONS. GO FORTH AND MAKE YOURSELVES PROUD AND YOU WILL MAKE US PROUD IN THE PROCESS.

(Regent Burton returns to his seat. President Shelton assumes the lectern.)

PRESIDENT SHELTON: ERNEST BRANDON WILL NOW LEAD US IN SINGING OUR PLEDGE, EASTERN MICHIGAN UNIVERSITY'S ALMA MATER. THE WORDS MAY BE FOUND ON THE BACK OF YOUR PROGRAM. PLEASE RISE.

(President Shelton steps back. Dr. Brandon assumes the lectern.)

DR. BRANDON: OUR PLEDGE (Alma Mater)

EASTERN, SACRED ALMA MATER, TO YOUR NAME WE SHALL BE TRUE,
EVER MARCHING ON TO VICTORY, WE'LL STAND BY TO SEE YOU THROUGH.
SOFTLY FLOATING ON THE BREEZE, VERDANT GREEN WITH WHITE OF SNOW,
THIS OUR BANNER WE WILL CARRY IN OUR HEARTS WHERE'ER WE GO.

(Dr. Brandon returns to his seat and remains standing. President Shelton assumes the lectern. Participants remain standing.)

PRESIDENT SHELTON: I WISH TO THANK THE UNIVERSITY SYMPHONIC CONCERT WINDS, CONDUCTOR MAX PLANK AND ERNEST BRANDON FOR THEIR PERFORMANCES HERE TODAY. (Pause) COMMENCEMENT IS A TIME FOR ENDINGS AND A TIME FOR BEGINNINGS, A TIME FOR SADNESS AND A TIME FOR CELEBRATION. AS YOU GRADUATE, I SINCERELY HOPE YOU WILL TAKE WITH YOU THE KNOWLEDGE AND UNDERSTANDING REQUIRED TO EXCEL IN OUR MODERN, COMPLEX WORLD, AS WELL AS WARM PERSONAL FRIENDSHIPS TO LAST THROUGH THE YEARS. WE AT EASTERN MICHIGAN UNIVERSITY TAKE PRIDE IN YOUR ACCOMPLISHMENTS AND WISH YOU WELL IN THE FUTURE.

PRESIDENT SHELTON: LADIES AND GENTLEMEN, AS WE PREPARE TO CONCLUDE THIS COMMENCEMENT PROGRAM, WE REQUEST THAT YOU REMAIN AT YOUR SEATS UNTIL THE RECESSIONAL IS ENTIRELY COMPLETED. I WOULD ALSO LIKE TO EXTEND AN INVITATION TO OUR NEW GRADUATES, THEIR FAMILIES AND FRIENDS, FACULTY AND STAFF TO JOIN US AT HOYT CONFERENCE CENTER FOR A RECEPTION CELEBRATING THIS OCCASION. HOYT IS A FIVE MINUTE WALK NORTH OF THE FIELD HOUSE.

THANK YOU AND CONGRATULATIONS.

(Participants replace caps. Remain standing. Wait until the ROTC color guard are in place.)

(Recessional is led by the Grand Marshal, followed next by the Color Guard and then the President leading the stage participants in the reverse order of the processional. Return to Warner where you may disrobe. A bus will escort stage participants back to Hoyt.)

RECESSIONAL